

LIVING & CO[®]

Rechargeable Epilator



Instruction Manual EP-02

AFTER SALES SUPPORT

☎ (NZ) 0800 422 274

CONTENTS

| | | |
|--|---------------------------|------------|
| IMPORTANT SAFETY INSTRUCTIONS | WARNINGS | 2-3 |
| | SAFETY PRECAUTIONS | 3-5 |
| | BATTERY REMOVAL | 5 |
| TECHNICAL DATA | | 5 |
| PRODUCT OVERVIEW | | 6 |
| CHARGING YOUR EPILATOR | | 6-7 |
| GENERAL INFORMATION ON EPILATOR | | 7 |
| USING YOUR EPILATOR | | 7-8 |
| CLEANING AND MAINTENANCE | | 9 |
| DISPOSAL | | 10 |
| WARRANTY | | 11 |

IMPORTANT SAFETY INSTRUCTIONS
PLEASE READ THE FOLLOWING SAFETY WARNINGS
AND THE INSTRUCTIONS CAREFULLY BEFORE USING
THE APPLIANCE AND KEEP FOR FUTURE REFERENCE.
WARNINGS

- This appliance is intended for domestic household use only and should not be used for any other purpose or in any other application, such as for non-domestic use or in a commercial environment.
- This appliance can be used by children aged from 8 years and above and persons with reduced physical, sensory or mental capabilities or lack of experience and knowledge if they have been given supervision or instruction concerning use of the appliance in a safe way and understand the hazards involved. Children shall not play with the appliance. Cleaning and user maintenance shall not be made by children without supervision.
- **WARNING:** Keep the appliance dry.
- **WARNING:** For the purposes of recharging the battery, only use the detachable supply unit provided with this appliance.
- The external flexible cable of the power supply cannot be replaced, if the cord is damaged, it is necessary to dispose of the power supply and obtain a replacement.
- Regarding the detailed instructions concerning the method and frequency of cleaning, please see section “Cleaning and Maintenance” on page 9.
- The battery must be removed from the appliance before it is discarded and then safely dispose of, check with your local council for information relating to suitable disposal location points.

IMPORTANT SAFETY INSTRUCTIONS CONTINUED

- The batteries (batteries installed) shall not be exposed to excessive heat such as sunshine, fire or the like.
- Dispose of used batteries according to the instructions.
- If battery leakage occurs, avoid contact with skin. Isolate the leaking battery in a sealed plastic bag and put it in the bin following disposal instructions. If contact with the skin, mucous membranes or eyes, rinse thoroughly with water and contact your doctor or ophthalmologist.
- The appliance is only to be used with the power supply unit provided with the appliance.
- Regarding the detail on how to remove the battery, refer to the section “Battery Removal” on page 5.

SAFETY PRECAUTIONS

- Do not reach for an appliance that has fallen into water. Unplug immediately.
- Do not place or store appliance where it can fall or be pulled into a tub or sink. Do not place in or drop into water or other liquid.
- Always turn off and disconnect the appliance from power adapter and then unplug the power adapter from the mains socket when not in use or before cleaning.
- Use this appliance only for its intended use as described in this manual. Do not use attachments not recommended by the manufacturer.
- Never drop or insert any object into any opening.
- Keep the cord away from heated surfaces.

- Never operate the appliance if it has a damaged cord or plug, if it is not working properly, if it has been dropped or damaged, or dropped into water. Return the appliance to a service center for examination and repair.
- Do not operate the appliance outdoors or operate where aerosol (spray) products are being used or where oxygen is being administered.
- **CAUTION:** Methods of removing hair by the root can cause in-grown hairs and minor skin injuries. Please consult your doctor if you have any questions about the use of the epilator.
- Do not use the epilator if you suffer from varicose veins, rashes, spots or blemishes, or when the skin is irritated or if you have in-grown hairs or a tendency to produce in-grown hairs. Consult your doctor first.
- The epilator should only be used after prior consultation with your doctor if you have or experience:
 - ✧ Open wounds
 - ✧ Eczema, psoriasis (scaly eczema), inflamed skin reactions such as folliculitis, skin rashes or the tendency to allergy or allergic skin reactions
 - ✧ Immune deficiency or disorders
 - ✧ Couperose, rosacea, or varicose veins
 - ✧ Pregnancy
 - ✧ Reduced skin immunity as a result of diabetes, pregnancy, Raynaud's disease, etc.
 - ✧ Hemophilia
 - ✧ If you have moles, raised skin bumps, etc.
 - ✧ If you have been or begin taking hormone medication, or recently been pregnant, a change in your hormone levels may influence the thickness, colour or amount of hair growth. This is caused by the hormonal changes, not by this method of hair removal.

- ✧ To prevent accidents and injury to you or damage to the appliance, when using the appliance keep it away from the hair on your head, eyelashes, eyebrows, clothing, brushes, wires, threads and cords etc.

BATTERY REMOVAL

- The epilator has a built-in 320mAh Lithium battery which is not readily accessible.
- Remove the built-in battery before disposing of the epilator.
- Disconnect the power cord from the epilator when removing the battery.
- Perform the steps 1 to 7 and lift the battery to remove it.

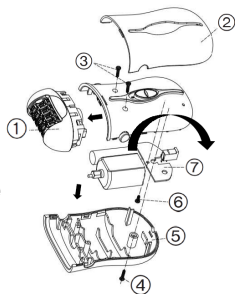

TECHNICAL DATA

Model: EP-02

Power adapter:

Input: 100-240V~ 50/60Hz 0.2A Max

Output: 5V DC 1000mA

Epilator: DC 5V  1000mA

PRODUCT OVERVIEW



- ① Epilating Head
- ② Epilating cap for legs/arms
- ③ Epilating head release button
- ④ On/off switch (high speed / low speed / off)
- ⑤ Epilating cap for underarms / bikini-line
- ⑥ Cleaning brush
- ⑦ Power adaptor (charger)

CHARGING YOUR EPILATOR

For best performance, fully charge the appliance before use.

Charging time: Approximately 1 hour 30 minutes
One full charge allows for 40 minutes of cordless operation.

1. Ensure that your epilator is switched off.

2. Attach the power adapter to the epilator and plug the power adapter into the mains socket.
 - The indicator light will illuminate, indicating that the battery is charging.
3. After charging is completed, unplug the power adapter from the mains socket and epilator.

GENERAL INFORMATION ON EPILATOR

- In some cases, inflammation of the skin can occur when bacteria penetrate the skin (when gliding the appliance over the skin). Thorough cleansing of the epilation head and cap after each use will minimize the risk of infection.
- When using an epilator for the first time, it is recommended that you begin at an area with little hair growth. This will help the skin adjust to the process of epilation.
- The optimum length of the hair for epilation is 3 – 4 mm. If hairs are longer, it is recommended that you shave or trim the hair first.
- If you experience some skin irritation after epilating, epilate in the evening as most skin irritation disappears overnight.
- After using your epilator, you can apply a non-alcoholic based mild cream or body lotion which will help reduce the possibility of skin irritation.

USING YOUR EPILATOR

Before epilating, make sure your skin is clean, dry and free from creams or oils.

Ensure that your epilator is switched off.

Attach the correct cap to the epilating head.

Switch on your epilator by selecting the desired speed (low / high). The indicator light will illuminate.

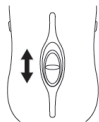

Epilating legs or arms

- Using your free hand, hold the skin taut so that the hairs stand upright. Position the epilator so that the tweezers are at a 90° angle and flat against the skin.
- Gently press and move the epilator slowly over the skin against the direction of hair growth. Do not apply pressure as the epilator will slow down or stop.
- Repeat until all unwanted hair is removed.

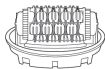

Epilating underarms or bikini-line

- When epilating the underarm area keep your arm raised so that the skin is stretched. If required, use your raised hand to pull underarm skin taught
- When epilating the bikini line hold the skin around the bikini line taut.
- Hold the epilator at a right angle to the skin and move it with light pressure against the direction of the hair growth.

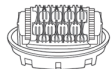

After epilating, switch off the epilator.

CLEANING AND MAINTENANCE

- After each use, turn off the epilator and clean it thoroughly.
- Press the release buttons on the both sides of your epilator to pull the epilating head with cap out of your epilator.
- Remove the cap from the epilating head.
- Use the supplied cleaning brush to brush the accumulated hair from the head.
- Never immerse the appliance in water or any other liquid.
- Never use abrasive or chemical cleaning agents.



DISPOSAL



As a responsible retailer we care about the environment. As such we urge you to follow the correct disposal procedure for the appliance and packaging materials and if applicable, batteries. This will help conserve natural resources and ensure that it is recycled in a manner that protects health and the environment.

You must dispose of this appliance and its packaging according to local laws and regulations. Because this appliance contains electronic components and may contain batteries, the appliance and its accessories must be disposed of separately from household waste when the appliance reaches its end of life.

Contact your local authority to learn about disposal and recycling.

We apologise for any inconvenience caused by minor inconsistencies in these instructions, which may occur as a result of product improvement and development.

LIVING & CO[®]



Warranty

We pride ourselves on producing a Range of quality home appliances that are both packed with features, and completely reliable.

We are so confident in our products, we pack them up with a 1 year warranty. Now you too can relax knowing that you are covered.

Customer Helpline NZ: 0800 422 274

This product is covered by a 1 year warranty when Accompanied by proof of purchase.

IM Version 1.0 – February 2020